



## **Introducing Netverse by Phinge, A New Rewards-based, Integrated Web Which Enhances Privacy, Security and Eliminates Apps**

Phinge Corporation May 31, 2022

[info@phinge.com](mailto:info@phinge.com) [www.Netverse.tech](http://www.Netverse.tech) 775-336-7245

Netverse will be an all new patented, rewards-based web for everyone, dramatically improving the user experience over the current web we all use today. Through its innovation, enhanced privacy, security, functionality and interoperability it strives to be the preferred web of the future.

### **Flaws With the Current Web**

- Fragmentation of technology, operating systems, Apps, API's, products and services [1]
- Marketplaces, Apps, websites and current technologies do not communicate with each other well or allow for seamless features and integration. [2] [3]
- Patched together systems, software and technologies that attempts to allow interoperability between cloud infrastructure systems not designed to work with each other [4] [5]
- Merchants and users services were not designed to communicate and share data, features or services with each other easily or seamlessly [6]
- Multiple accounts, usernames and passwords are needed [7]
- Companies collect, harvest and sell user data with vague, little or no consent from the user [8] [9]
- Extensive advertising, spam, phishing and scams [10]
- No user accountability outside of the services or App(s) they use [11]
- Toxicity, violence, bullying and other issues are prevalent [12]

## **How Netverse Endeavors to Solve These Issues Through the Creation of a New, Better Web**

- Universal Integrated Code base for all partner merchants and users to develop on with top level username, integrated features, universal enhanced privacy and security
- Interoperability designed in from the beginning versus pieced together over time
- Allows merchants and users to interact and share data instantly and dynamically based on their individual, granular privacy settings
- Approved and verified users and merchants through authorized hardware devices create a verified ecosystem reducing fraud, spam and bad behavior
- Users and merchants own all their data at all times and privacy and data permissions are always in their control
- More customizable, less invasive advertising is always controlled by the user
- Revolutionary, universal privacy through content filtering and sorting controls is given to every Netverse user and merchant

## **Introduction to Netverse, Universal, Integrated, Code Base**

Netverse is a Privacy-first Rewards-based, Universal Integrated Code Base that allows any platform on it to instantly exchange data between anyone and everyone effortlessly, individually or all at once. All platforms on Netverse do not run locally on authorized users devices, There is no downloading, installing or updating of platforms on users devices like Apps require on the current web, instead all platforms and data is stored and executed on Netverse hardware server clusters then delivered to a users authorized user device. Data is dynamically updated and accessible freely by any user, merchant, and platform developer on Netverse subject to the current permissions of each owner of that data.

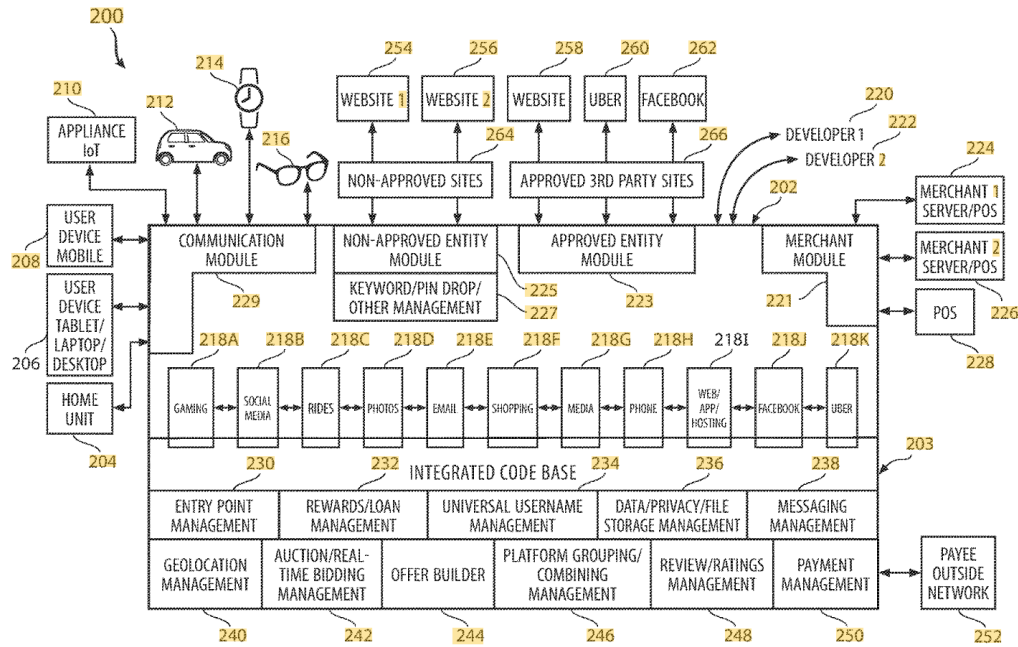

## Netverse, Major Differences and Improvements

- Authorized devices and hardware
- Closed secure ecosystem of hardware and software
- Rewards-based integration throughout
- Integrated dynamic controlled security
- Data as a process
- Server based

## Authorized User Devices and Hardware



- **Proprietary Devices (No third party)**

Hardware invented, patented, developed and built by Phinge, fully integrated with Netverse

- **Consumer and Merchant Electronic Devices and Peripherals**

Mobile hardware, devices, peripherals, POS systems, AR/VR and emerging technologies

- **Verified Devices**

Devices are authenticated and activated via real world identification of individuals at the time of purchase

## Secure Ecosystem of Hardware and Software, Distinctive Differences Explained

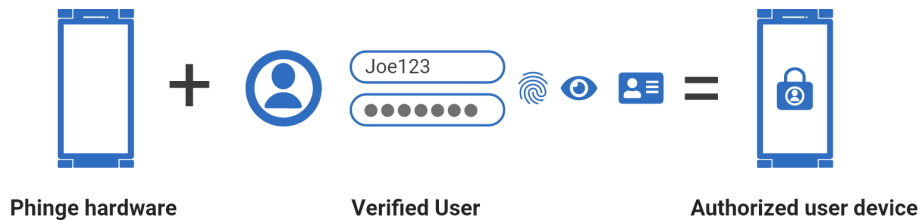

- **Enhanced Privacy**

Users own, control and manage all of their own data at all times. Users and merchants always decide how their data is accessed by other users and merchants within Netverse. Including the Right to Forget at any time

- **Affordability**

Netverse integrated services and marketing tools are freely available for all Netverse users and merchants including technical and other support at any time for no cost through their available, earned rewards

- **Interoperability**

Phinge software and hardware systems operate seamlessly creating a unified web through a universal, integrated code base. The ability to instantly switch and combine numerous platforms without accessing or opening them. Easy integration with existing and upcoming technologies and hardware.

- **Digital Stewardship**

True Digital Ownership of any data or content, that can be monetized, exchanged, shared, loaned, rented or bought and sold between any entities inside or outside of Netverse

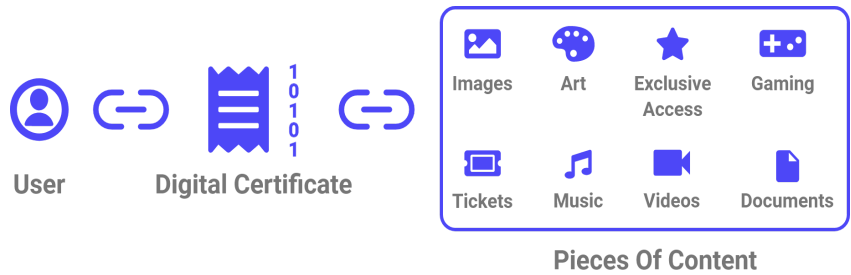

## Benefits of a Rewards-based Web



- **Economy of Rewards**

Rewards are earned via the purchasing of goods or services on Netverse, Rewards can be earned via specific platform actions or globally on Netverse. Rewards have dollar-for-dollar value and can be used and exchanged for any goods or services on Netverse [\[a\]](#)

- **Ease of Universal Rewards**

Rewards integrate seamlessly throughout the entire Netverse experience. Rewards can be earned by registering, purchasing, referring, sharing and more. Rewards do not expire subject to terms of use

# Netverse of Everything

Rewards From Home Appliances and More



## Earn Rewards Through Netverse Appliances And Devices

Netverse will be made available to appliance and home device manufacturers. Appliances with Netverse will reward you for all purchases made through them. Your available rewards may also be used towards your purchases as well. You may even save up your rewards to purchase other Netverse powered devices.  
[Learn More >](#)

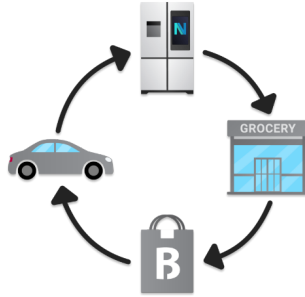

## Earning Rewards Is Easy

- 1. Order Through A Netverse Powered Refrigerator:**  
You may use your available Phreewards towards your purchase.
- 2. Submit Order Instantly:**  
The grocery store receives your order
- 3. Order Prepared By The Store**
- 4. Delivery Through Bid:**  
Your groceries are delivered to you.
- 5. Groceries Delivered:**  
You have received Phreewards based on your purchase amount.

- **Redeeming and Sending Rewards**

Rewards may always be redeemed the same as cash through every merchant on Netverse. Rewards may be sent, received, loaned and gifted to any user or entity on Netverse [b]

## Benefits of Integrated, Dynamically Controlled Privacy and Security Explained

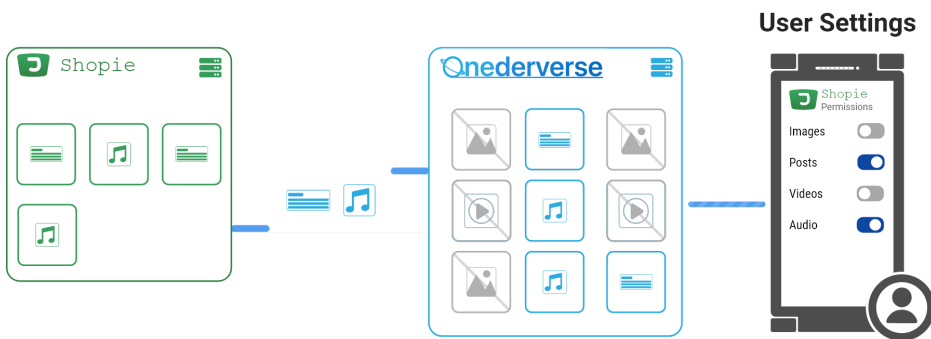

- **User Controlled Security**

Users always have total and complete granular control over their data, privacy and security throughout Netverse, Users may choose to have absolute anonymity and can choose to share nothing, everything or anything in between within Netverse.

- **Data Security**

Blind encryption and biometric control and on-board security hardware and device level encryption

- **Universal Security Protocol**

Netverse is a closed security system that has security checks throughout, that enhances, protects and improves the users experience

- **Device Security**

Hardware and software based security for all user devices

- **Netverse System Security**

Proprietary, innovative new security features and systems for users and merchants throughout Netverse

- **Real Authentication**

Using a combination of biometrics and real world identification, all individuals and entities on Netverse will be verified prior to being allowed on Netverse through its hardware. Spam, scams, phishing and other malicious advertising and attempts to capture a user's data will be heavily reduced through Netverse in part through segmented data of any size, through granular filtering, sharing and display of any piece of data (ex. Social media posts can be filtered by images, links, media and word counts to individual users, age groups, platforms and more.)



## Netverse Privacy, Security and Real-time, Verified Authentication

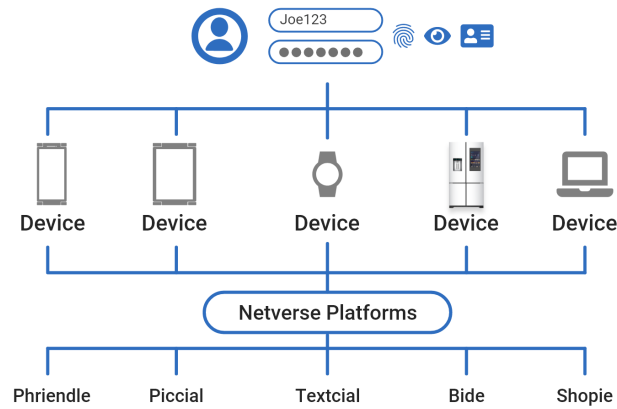

## Data-as-a-Process Diagrammed

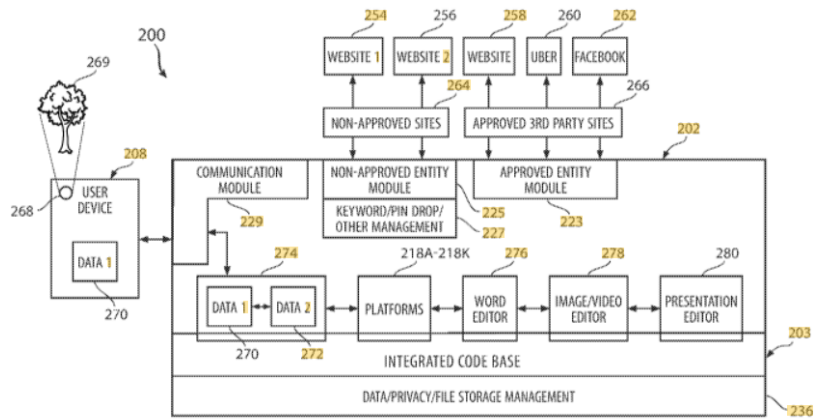

- Ownership of Data: Example 1 End users filter receiving data

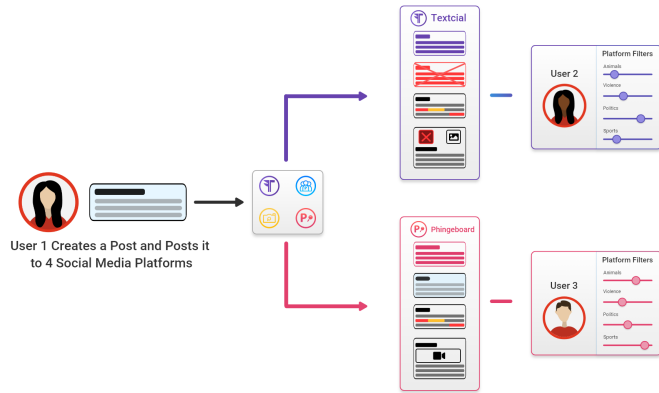

- Example 2 Data owner sets filters on data prior to submission

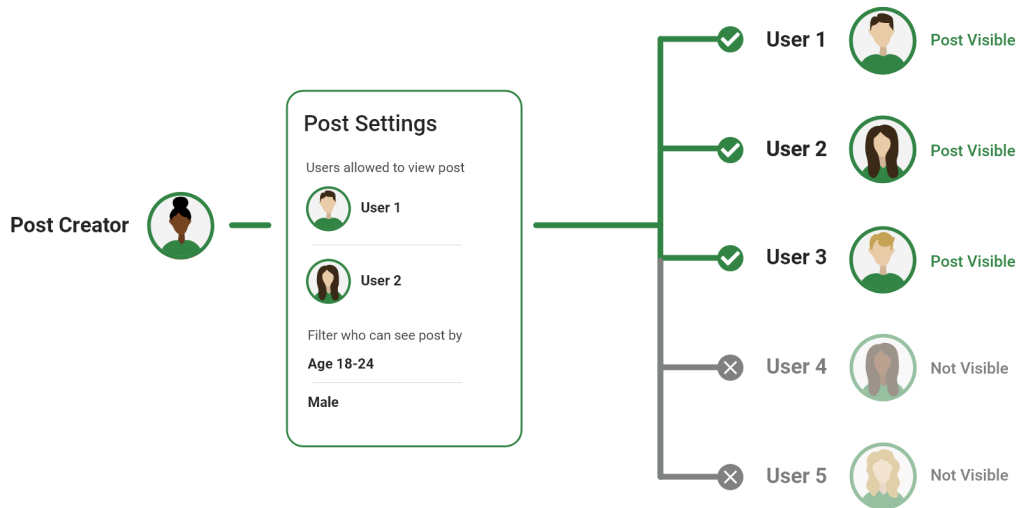

- **Dynamic Real-time Data**

Data is dynamic, never static, and is continuously evolving and changing per user's interactions. Data is always available to be accessed by any authorized entity within Netverse subject to each data owner (users) current permissions. Permissions may be modified, turned on or off by the owner of the data at any time or by pre-selected events, day, date and times.

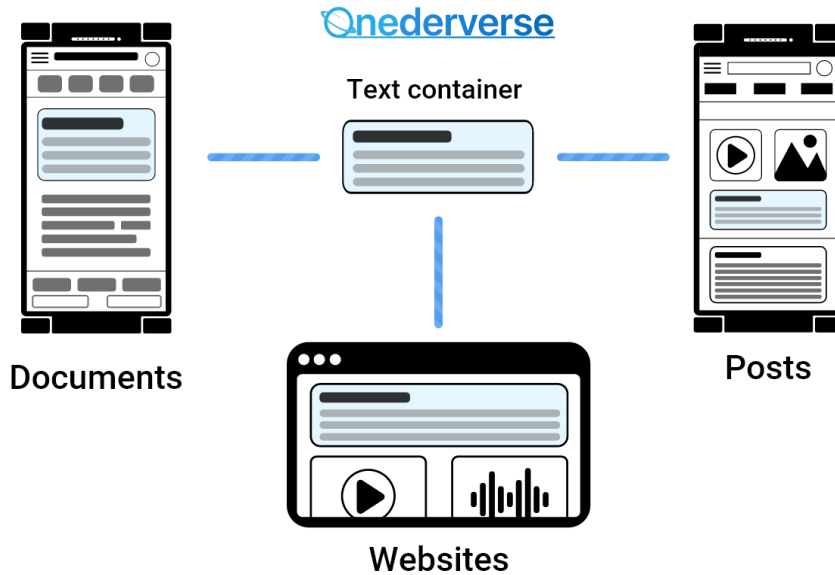

## Minimal Localized Computing

### APPS Are Now Platforms

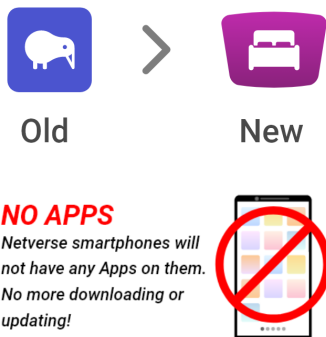

### Netverse is continually updated

when netverse updates, so does your device

*No more operating system updates and downloads to manage, netverse is always up to date all the time*

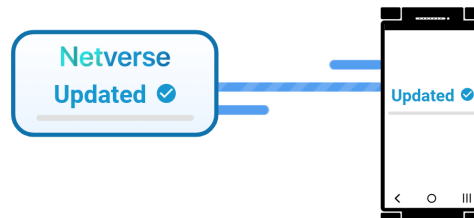

- **No Downloading, Installing, Execution or Updating Platforms on Netverse Through Its Authorized Hardware**

No localized applications exist or execute on a user's device. Data is sent to the user's device from Netverse based on the user's interaction with it. User experiences can be standardized but can be further customized based on each user's preferences.

- **No Updating (Always Updated)**

Netverse and its platforms are continuously updated through the universal, integrated code base. No need for user's to update an operating system (there isn't one), install patches, updates, new features or software revisions. Users on Netverse always have the latest version instantly while interacting with it and everytime they access Netverse.

- **Innovative Computing**

Most computing will be done independent of the user's local authorized hardware which optimizes systems local resources. Netverse will utilize revolutionary, patented software, hardware and technologies.

## **Netverse, a Practical Example**

[Link to Interactive Demo of Netverse Practical Uses and Features](#)

- **Netverse Users**

With Netverse a user can switch and combine multiple platforms feeds and timelines together into a single viewer and sort and filter in anyway they choose. Buy and sell physical and digital goods, earn rewards and spend rewards anywhere throughout Netverse. A portion of every sale goes to a charity of the users choice, paid by Phinge. Netverse users have the ability to instantly modify or change their privacy and data settings at any time, anywhere throughout Netverse. Everyone can create, modify, sort, and filter anything from their social media postings to personal documents and files instantly and globally throughout Netverse

- **Netverse Approved Merchants**

Create or add your business, and use a full suite of integrated tools to manage and grow your business. Merchants on Netverse can share data, statistics and analytics between each other, earn and accept Phreewards on purchases that are valued the same as cash, view and manage real-time statistics of Netverse purchases from users and adjust inventory, pricing and promotions in real-time.. Exchange and send real-time data between any other merchants on Netverse. Manage employees, payroll, inventory ordering, shipping and logistics in real-time.

## **Conclusion**

Netverse will be the first rewards-based alternative to the web we all use today. It will be the safest, most secure web with users owning and controlling all of their data at all times. Privacy and security will be enhanced through verified and authenticated users which will reduce fraud and bad behavior. It will provide a faster, more enjoyable experience through its authorized hardware in part by not having any Apps to install or update on them. Netverse will always be the latest updated version every time it is accessed and used. It will provide total interoperability by allowing all platforms within Netverse to be combined or switched between instantly. Netverse will be fully rewards-based. Every user and business will earn rewards and have the ability to redeem them from every user and merchant selling products and services on Netverse. Netverse will also enhance the experience with AR and VR including gaming through Netaverse and its associated hardware. Simply put, Netverse will make the future more rewarding for all.

**You may view some of the Netverse related software and hardware patents at [www.PhingePatents.com](http://www.PhingePatents.com)**

## Footnotes

[a] Rewards are given as a percentage of the sale with a percentage going as a rebate to the purchasing user, purchasing users chosen charity, purchasing users referrer, purchasing users product or service referrers comment, share, recommendation, review etc. and partner merchant.

[b] Users are responsible to pay all applicable taxes and fees with their credit or debit cards through PhingePay.

# PHINGE

Visit [www.Phinge.com](http://www.Phinge.com) for more information

© 2022 Phinge Corporation

**Note:** The contents herein are a high level introduction to Netverse. It is not a complete description of its entirety and as such will also continue to evolve over time.